

HOW TO CHANGE THE GFCI CASING

In order to change the casing of a defective GFCI plug, follow these steps:

REQUIRED PARTS

You will need:

- New GFCI plug
- A screwdriver

Parts are available from your local retailer.



- 1 Make sure that the length of the drawn wire matches the illustration:



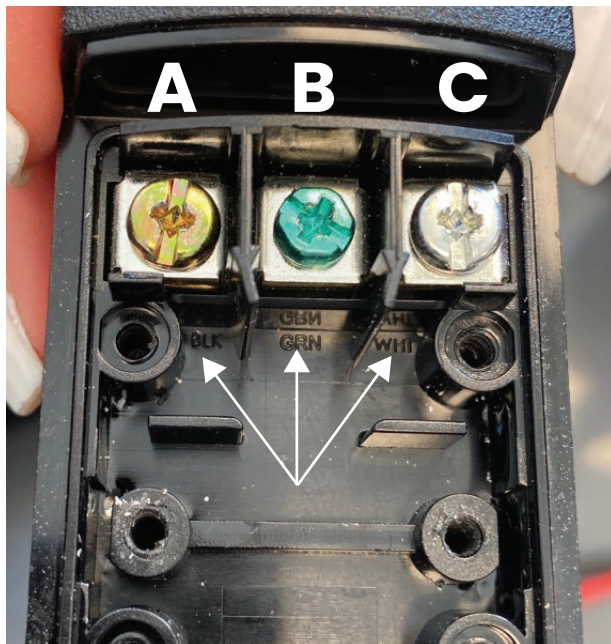

2 The wires have a specific position according to their color:

- A. The yellow screw - black/blk
- B. The green screw - green/grn
- C. The silver screw - white/wht



3 Place one wire at a time in its position, according to the color.

Be careful, each wire must be inserted to the very bottom;

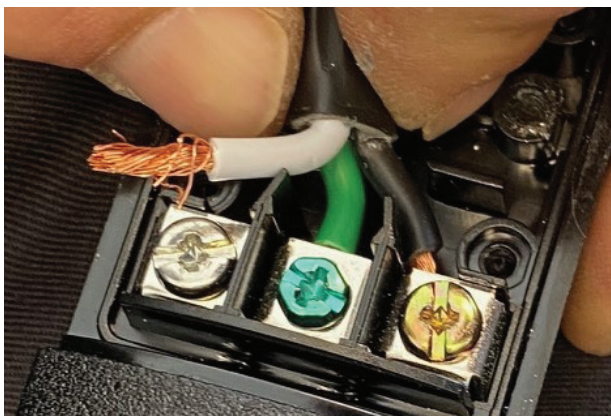

4 Tighten each screw;

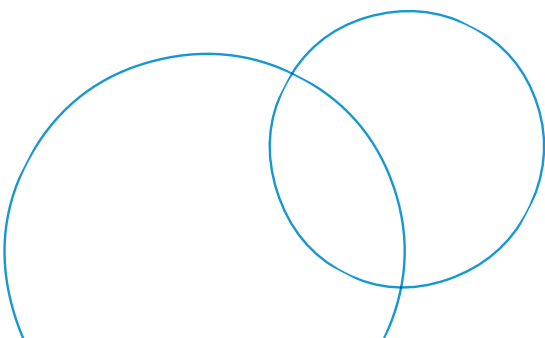
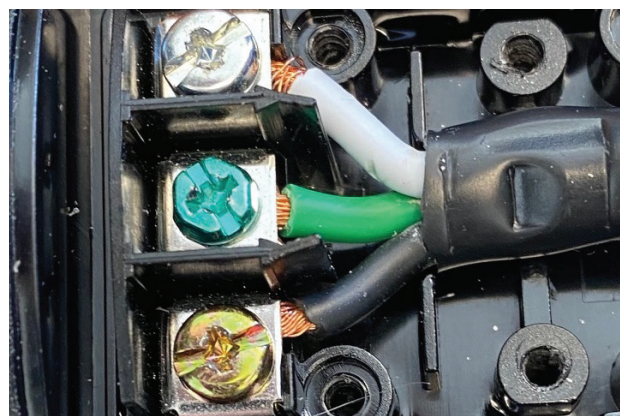
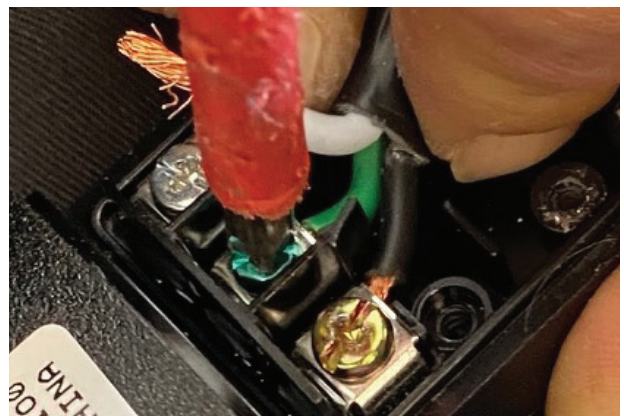

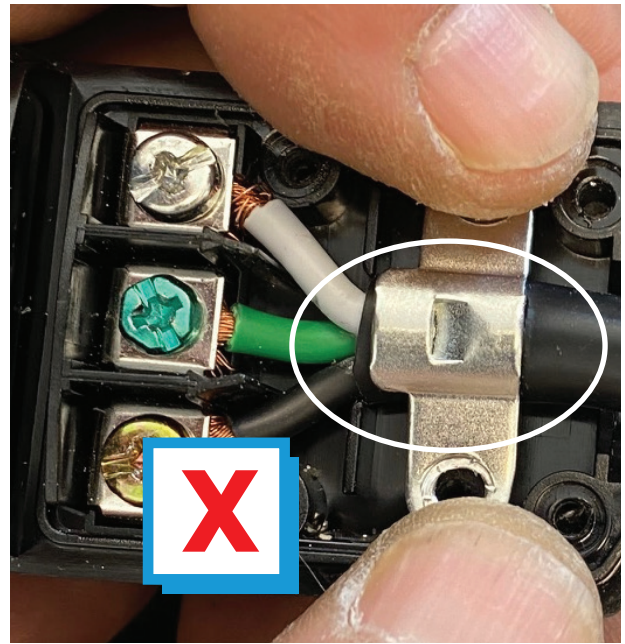
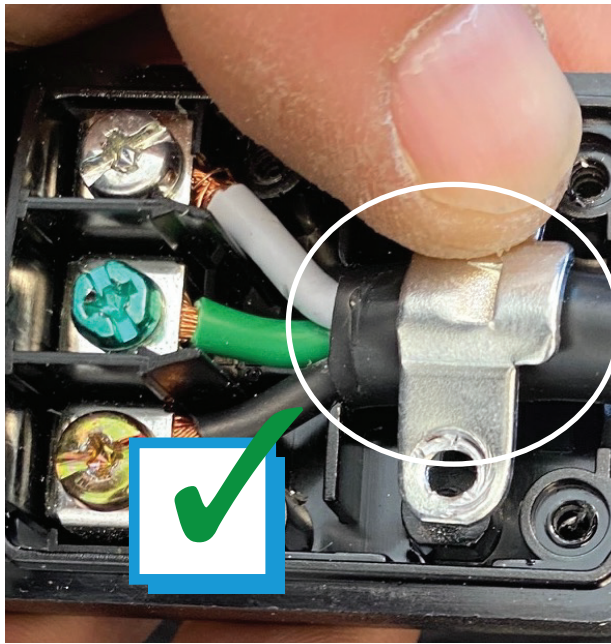

- 5** Add the metal plate and screw. Make sure to put it on the right side as above:

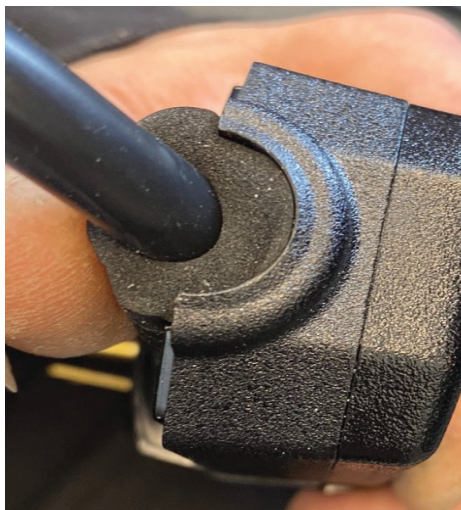
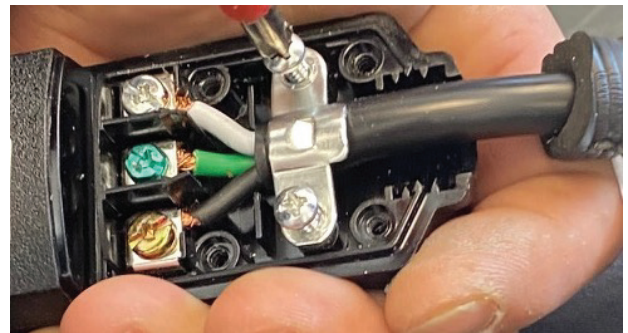

- 6** Make sure the small pad is placed against the panel and close the plug;



Questions?

For any questions, please contact our service department:
1 866 995-8646, ext 226 or 227